

Tips & Technology

For Bosch business partners

Current topics for successful workshops No. 11/2014

Gasoline Injection



BOSCH

Invented for life

Installing Bosch Spark Plugs

Changing spark plugs is actually a task that is frequently carried out by the vehicle owner. Nevertheless, there are a few things to keep in mind. On modern vehicles in particular, the spark plugs should be changed by a specialist who has the correct tools. There is otherwise the danger of damaging the spark plugs as the result of incorrect installation or removal.

You can find step-by-step instructions for safely installing spark plugs in the following.

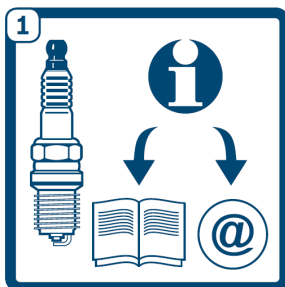

1. Where you find the appropriate spark plug

Which Bosch spark plug is correct for your application can be found in the Bosch spark plug catalog or online at

www.bosch-automotive-catalog.com

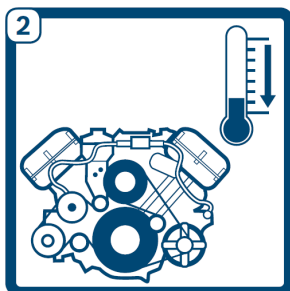

2. For your own safety

Before starting installation, allow the engine to cool. This is not only for your safety; it also makes it easier to unscrew the spark plug.

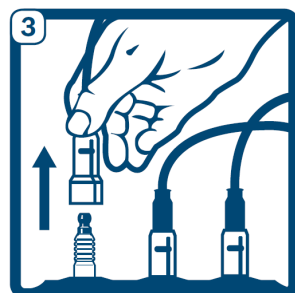

3. Proceed step-by-step

Change the spark plugs one after the other. Remove the spark plug connector only for the plug you are currently replacing.

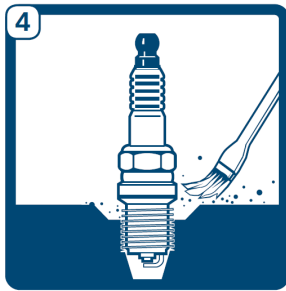

4. Please clean up first

Clean the cylinder head around the spark plug before you remove the spark plug.

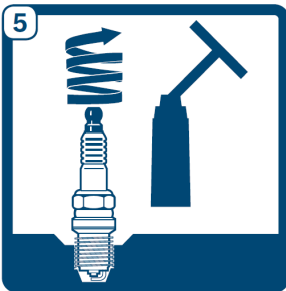

5. Unscrew the spark plug

Loosen the spark plug and then unscrew it completely. Make sure that the spark plug does not fall out of the spark plug / hexagon socket.

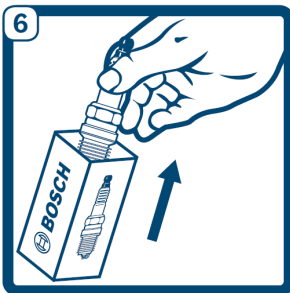

6. Pick up the new spark plug

You can now start installing the new spark plug. Remove your Bosch spark plug from its package.

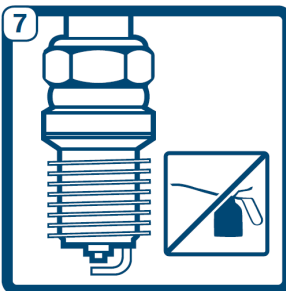

7. Please note

Data regarding the torque is based on dry threads and new seal rings; accordingly, the threads must not be boiled or greased.

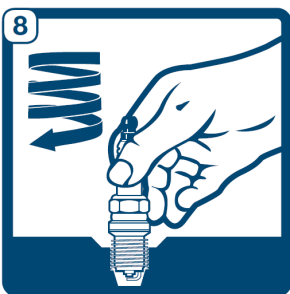

8. Screw the spark plug in by hand

Carefully screw in the spark plug by hand until it seats against the cylinder head. Now refer to step 9 and proceed in accordance with your spark plug type.

9a) Spark plug with a flat seat and compressible seal ring

M10x1	12 Nm	90°
M12x1,25	23 Nm	90°
M14x1,25 <13 mm	17 Nm	90°
M14x1,25 >13 mm	28 Nm	90°
M18x1,5	38 Nm	90°

Here, the spark plug can be tightened to an angle or with the aid of a torque wrench. The tightening torque or angle can be found in Table 9a.

9b) Spark plug with a flat seat and solid seal ring

M12x1,25	23 Nm	X
----------	-------	---

Here, the spark plug may be tightened only with a torque wrench. Attention: Do not tighten to an angle! For the tightening torque, see Table 9b.

9c) Spark plug with conical seat without seal ring

M14x1,25	15 Nm	15°
M18x1,5	20 Nm	15°

Here, the spark plug can be tightened to an angle or with the aid of a torque wrench. The tightening torque or angle can be found in Table 9c.

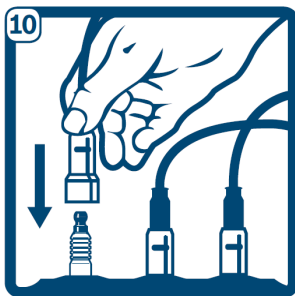

10. Reattach the spark plug connector

Now, reattach the connector to the spark plug that you just replaced.

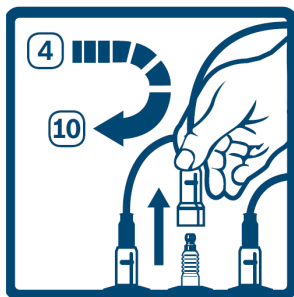

Proceed according to steps 4 to 10 for the remaining spark plugs.